



**Strategic Solutions Unlimited, Inc.**

DUNS: 807784462  
CAGE: 4W4R1

**Standard Features**

Certifications

- ♦ Awarded a Safety Certificate from the U.S. Army Natick Soldier Research, Development and Engineering Center (NSRDEC) in March 2013

Structural Insulated Panels (SIP)

- ♦ Foam core sandwiched between two (2) structural facings
- ♦ Recommended facing options are marine grade plywood and/or 26 gauge sheet metal
- ♦ Provides an insulation rating of up to R26
- ♦ Extremely strong, **energy efficient**, and cost effective

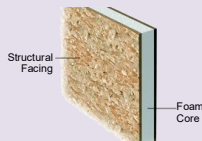

Protective Coating

- ♦ Permanent polymer slip resistant coating
- ♦ Non-toxic, durable, fire retardant
- ♦ Barrier against mold, mildew, water, chemicals, temperature, and years of use
- ♦ Applications or treatments can be applied to reduce visual, IR, and radar signatures
- ♦ Color choices available

Cam Lock Assembly with Tongue and Groove Panel Guides

- ♦ Cam locks placed every two (2) feet to provide a strong, fully sealed joint with significant strength
- ♦ Tongue and Groove system provides quick and easy assembly
- ♦ Ease of assembly allows for use of non-skilled labor for construction

HVAC Unit

- ♦ Customizable to function with any structure available.

Electrical

- ♦ Fully pre-wired according to client's needs
- ♦ 100 Amp electrical panel with Hubbell connectors included
- ♦ Configurable to accept 110v or 220v power sources
- ♦ Can accept commercial, generator, or solar power
- ♦ Panel is detached for shipping but easily installed with a screwdriver



Internal Lighting

- ♦ Recessed in roof panel
- ♦ 3/4" Lexan protective covering
- ♦ Fluorescent bulbs standard
- ♦ LED lighting upgrades available

Tools & Equipment

- ♦ Panels can be moved by 3 personnel
- ♦ Hex wrench to activate cam locks
- ♦ Screwdriver for electrical box and HVAC hoses
- ♦ All tools needed are included with EPC



# Expeditionary Pod Construction (EPC)

## BASE EPC SYSTEM

The Single EPC is the base unit of the EPC system, and provides a highly versatile workspace to meet any customer requirement. Containing approximately 46 sf of interior space, suggested uses for this variant include office space, billeting, storage, and bathroom facilities complete with plumbing. Benefiting from the lightweight SIP panels, a single EPC weights only 1,400 lbs.

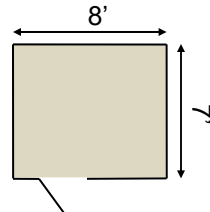

**Exterior Dimensions**

- ♦ 84" Depth (7')
- ♦ 96" Width (8')
- ♦ 96" Height (8')

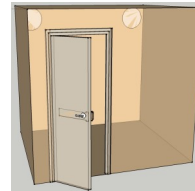

**Interior Dimensions**

- ♦ 76" Depth (6'4")
- ♦ 87" Width (7'3")
- ♦ 87" Height (7'3")

## UNIQUE FEATURES

The Single EPC features the ability to install a mobility/alignment system. Consisting of hand-cranked wheel jacks mounted on the outside of the EPC, the alignment system allows users to easily organize, arrange, and level the EPCs on most surfaces.



## INTERVIEW MODULE & OPERATIONS SUPPORT MODULE (2 POD)

The two (2) Pod EPC is the most frequently requested and fielded EPC variant, it provides a highly versatile workspace to meet any customer requirement. The standard version of this variant contains approximately 90 sf of interior space, suggested uses are for office space and billeting.

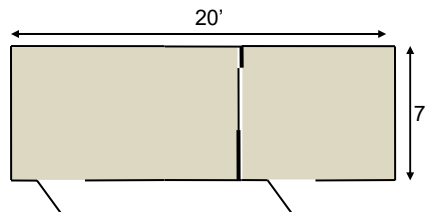

**Exterior Dimensions**

- ♦ 84" Depth (7')
- ♦ 240" Width (20')
- ♦ 96" Height (8')

**Interior Dimensions**

- ♦ 76" Depth (6'4")
- ♦ 231" Width (19'25")
- ♦ 87" Height (7'3")

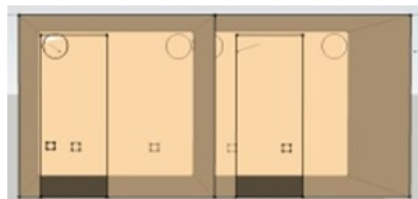

Jan '22

Todd Burns, Director Business Development  
burnst@ssuinc.us -or- info@ssuinc.us  
(910) 222-8138

225 Gray St.  
Fayetteville, NC 28301  
www.ssuinc.us



## Expeditionary Pod Construction (EPC)

### COMMAND AND CONTROL MODULE (3 POD)

When less working space is needed or when space is a concern at installation sites, the three (3) Pod EPC contains over 130 sf of living or working space to meet customer needs. The back wall of the EPC measures 16' and the long side wall measures 14'.

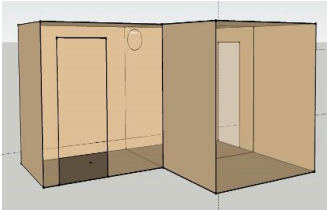

#### Interior Dimensions

- ◆ 159" Depth (13'3")
- ◆ 183" Width (15'3")
- ◆ 87" Height (7'3")

#### Exterior Dimensions

- ◆ 168" Depth (14')
- ◆ 192" Width (16')
- ◆ 96" Height (8')

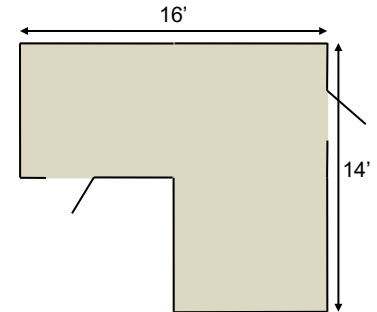

### COMMAND AND CONTROL SUITE (5 POD)

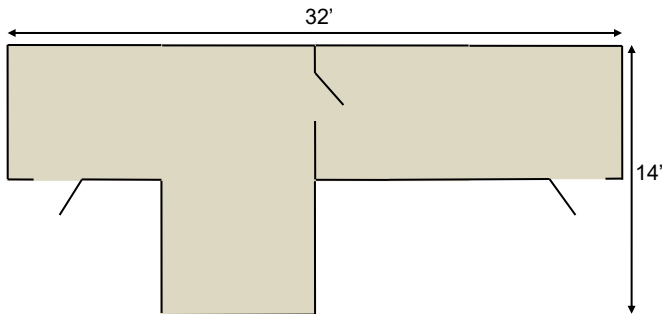

If more space is needed or available, the five (5) pod EPC provides over 220 sf of working space. Also, the five pod EPC can be sectioned into two separate work areas via doorway to provide a personal workspace.



#### Exterior Dimensions

- ◆ 168" Depth (14')
- ◆ 384" Width (32')
- ◆ 96" Height (8')

#### Interior Dimensions

- ◆ 159" Depth (13'3")
- ◆ 375" Width (31'3")
- ◆ 87" Height (7'3")

### TRANSPORTATION

We understand how valuable our clients' time is, so we make it our goal to deliver our EPCs to our clients as quickly and efficiently as possible. Our process for shipping greatly reduces the logistical footprint for our clients and provides significant transportation savings.

